

Berthoud-Heritage Metropolitan District Nos. 1-17

c/o Pinnacle Consulting Group, Inc.
550 W. Eisenhower Blvd | Loveland, CO 80537
Phone: (970) 669-3611 * Fax: (970) 669-3612
BHMDadmin@pcgi.com

December 14, 2022

Larimer County Assessor
200 W. Oak Street
Fort Collins, CO 80522-1190

Via Email: MillerS@co.larimer.co.us
cc:fordla@co.larimer.co.us

NOTICES/FILING SYSTEM
Larimer County Clerk and Recorder
200 W. Oak St.
Ft. Collins, CO 80521

Via Online Filing Portal

State of Colorado
Department of Local Affairs
1313 Sherman Street, Suite 521
Denver, CO 80203

Via E-Filing Portal
Berthoud Heritage Metro No. 1 (#66006)
Berthoud Heritage Metro No. 2 (#66007)
Berthoud Heritage Metro No. 3 (#66008)
Berthoud Heritage Metro No. 4 (#66009)
Berthoud Heritage Metro No. 5 (#66010)
Berthoud Heritage Metro No. 6 (#66011)
Berthoud Heritage Metro No. 7 (#66012)
Berthoud Heritage Metro No. 8 (#66013)
Berthoud Heritage Metro No. 9 (#66014)
Berthoud Heritage Metro No. 10 (#67066)
Berthoud Heritage Metro No. 11 (#67067)
Berthoud Heritage Metro No. 12 (#67068)
Berthoud Heritage Metro No. 13 (#67069)
Berthoud Heritage Metro No. 14 (#67070)
Berthoud Heritage Metro No. 15 (#67071)
Berthoud Heritage Metro No. 16 (#67072)
Berthoud Heritage Metro No. 17 (#67073)

Dear Sir or Ma'am:

As required by statute (C.R.S. 32-1-306) and 32-1-104 (3)(b), all Title 32 Article 1 special districts are required to file a current, accurate map of district boundaries with the County Clerk and Recorder, Assessor and Division of Local Government.

On behalf of **Berthoud-Heritage Metropolitan District Nos. 1-17**, please accept the attached updated District boundary map. The District(s) are wholly located within Larimer County.

Please feel free to contact me with any questions or concerns.
Sincerely,

**BERTHOUD-HERITAGE METROPOLITAN
DISTRICT NOS. 1-17**

s/Kieyesia Conaway
District Administrator

BERTHOUD-HERITAGE METROPOLITAN DISTRICTS 1-17 MAP

LOCATED IN SECTIONS 3, 4, 9, 10, 11, 14 AND 15, TOWNSHIP 4 NORTH, RANGE 69 WEST, 6th P.M.
TOWN OF BERTHOUD, COUNTY OF LARIMER, STATE OF COLORADO

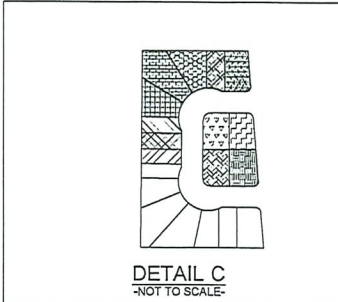
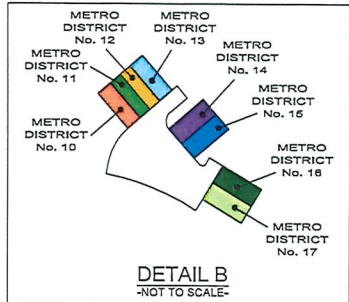
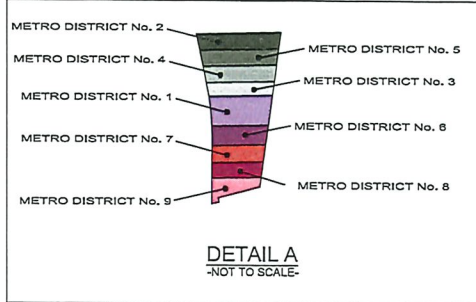
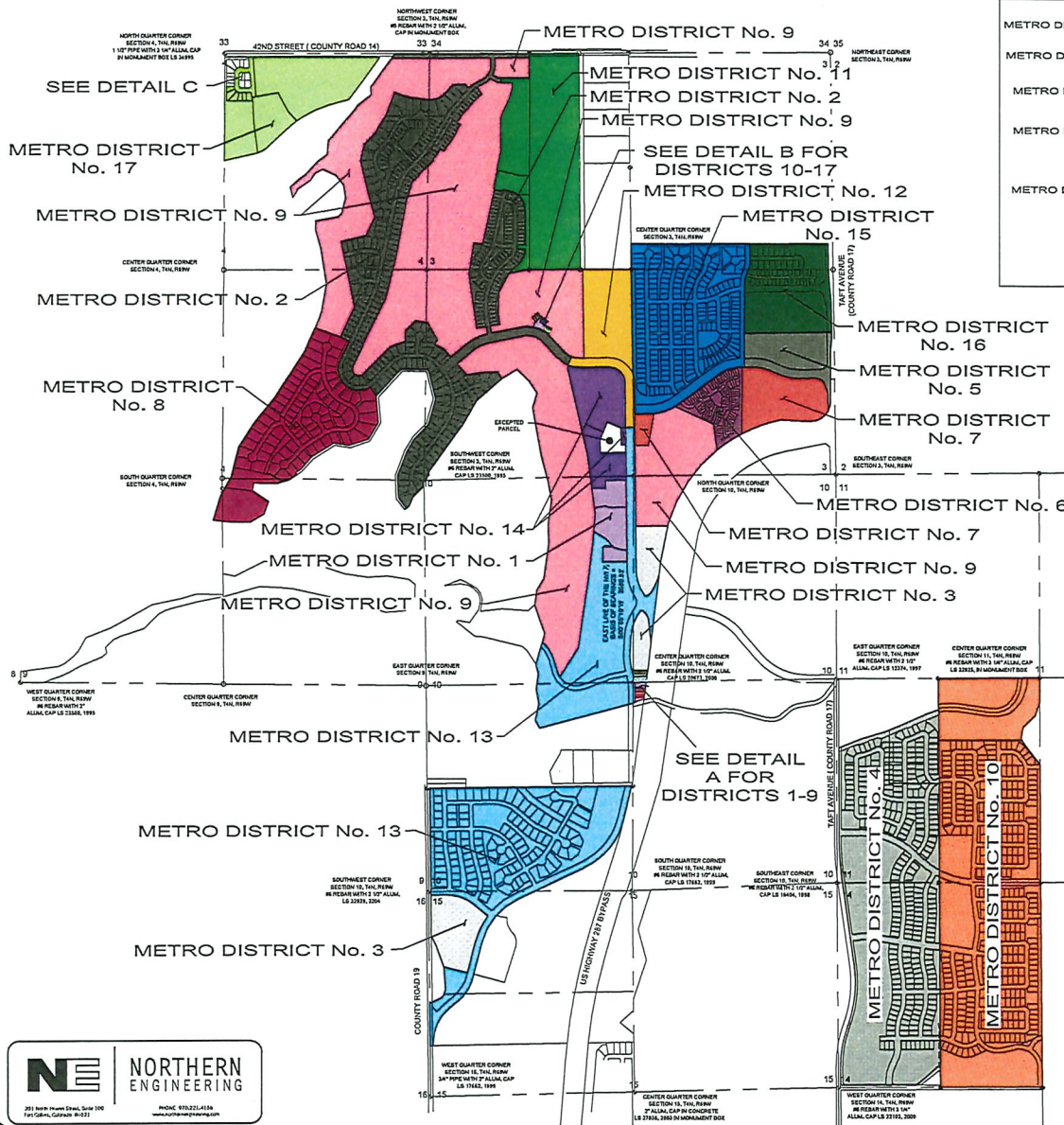

- LEGEND:**
- Section Corner
 - Metro District No.1
 - Metro District No.2
 - Metro District No.3
 - Metro District No.4
 - Metro District No.5
 - Metro District No.6
 - Metro District No.7
 - Metro District No.8
 - Metro District No.9
 - Metro District No.10
 - Metro District No.11
 - Metro District No.12
 - Metro District No.13
 - Metro District No.14
 - Metro District No.15
 - Metro District No.16
 - Metro District No.17

DISTRICT ACREAGE:

METRO DISTRICT	ACREAGE	%
METRO DISTRICT #1	405,022	9.37%
METRO DISTRICT #2	4,803,355	110.27%
METRO DISTRICT #3	965,922	22.25%
METRO DISTRICT #4	5,691,920	130.66%
METRO DISTRICT #5	652,314	14.97%
METRO DISTRICT #6	483,635	11.03%
METRO DISTRICT #7	785,066	18.09%
METRO DISTRICT #8	2,232,133	51.35%
METRO DISTRICT #9	9,924,068	227.56%
METRO DISTRICT #10	6,917,591	158.86%
METRO DISTRICT #11	2,441,688	56.63%
METRO DISTRICT #12	924,793	21.30%
METRO DISTRICT #13	5,809,224	134.27%
METRO DISTRICT #14	729,078	17.00%
METRO DISTRICT #15	2,888,451	66.31%
METRO DISTRICT #16	1,258,000	28.86%
METRO DISTRICT #17	3,455,119	79.50%

DRAFT

10-26-22

PRELIMINARY - NOT FOR CONSTRUCTION, RECORDING PURPOSES OR IMPLEMENTATION

October, 2022

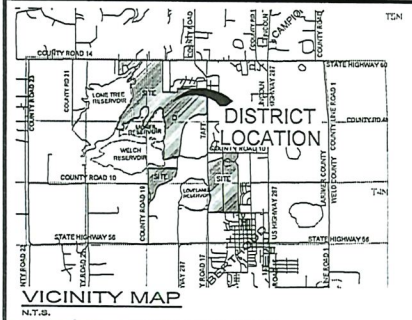

BERTHOUD-HERITAGE Metropolitan Districts
DISTRICT MAP

NE NORTHERN ENGINEERING
251 North Truman Street, Suite 100 Fort Collins, Colorado 80521
PHONE: 970.221.4138
WWW.NORTHERNENGINEERING.COM

